

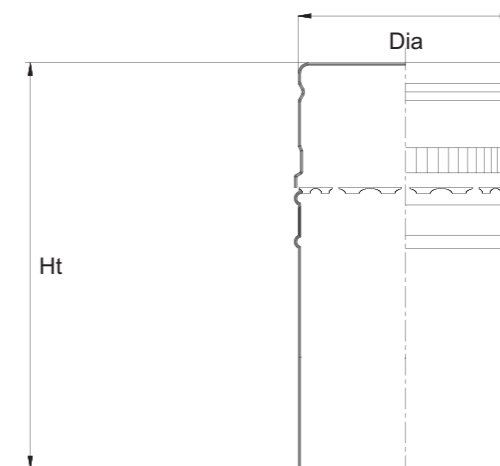

METAL CLOSURES

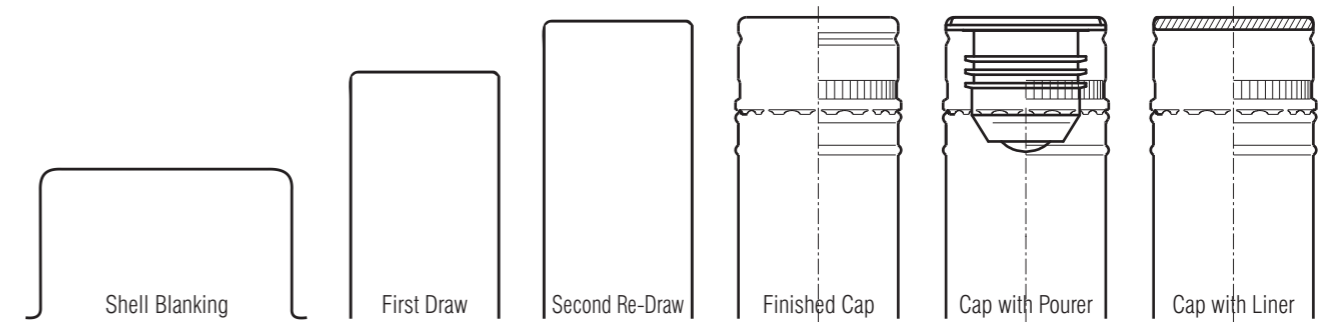

Production process - flow



Cap size	Dia max	Ht max	Reg/NC	TE	KC	SC	KSC	DOP
30/44	29.90	44.20	✓	✓	✓	✓	✓	✓
30/55	29.90	55.20	✓	✓	✓	✓	✓	✓
30/60	29.90	60.20	✓	✓	✓	✓	✓	✓
31/44	31.80	44.20	✓	✓	✓	✓	✓	✓
31/60	31.80	60.20	✓	✓	✓	✓	✓	✓

Reg/NC - regular (or) non -chamfered
 TE - top embossed
 KC - knurl chamfered
 ✓ - available

SC - side chamfered
 KSC - knurl and side chamfered
 DOP - dry offset printed

METTLECAP / SCREWCAPS

Metal Closures Private Limited
(an ISO 9001:2008 certified company)

Corporate office: 12th K.M., Kanakapura Road, Bangalore 560062, India.
Ph: +91 80 2608 7200 Fax +91 80 2632 0020
e-mail: admin@metalclosures.com www.metalclosures.com